

Boat transom

326

**Step 1: Drill the hole**  
Preference dimension card (with holes size) help to install the outboard in appropriate position on the transom.

**Step 2: Detach the motor top cover**  
Before lifting, tidy up the cables and secure them to the motor. Detach the four M5 screws from the outboard motor cover.

**Step 3: Lifting the machine**  
Screw in the lifting ring until tight. Use a lifting rope to secure the machine and attach it to the hoist. Slowly adjust the hoist during a trial lift. If the machine remains stable without tilting or swinging, you may proceed with the proper lift.  
Lifting objects hazard: pay attention to safety when hoisting equipment or objects nearby to avoid being hurt or crushed by falling objects.  
Note: Please install the outboard motor correctly and securely, as improper installation of the outboard motor may result in unforeseen damage to the outboard motor, equipment, and personal injury.

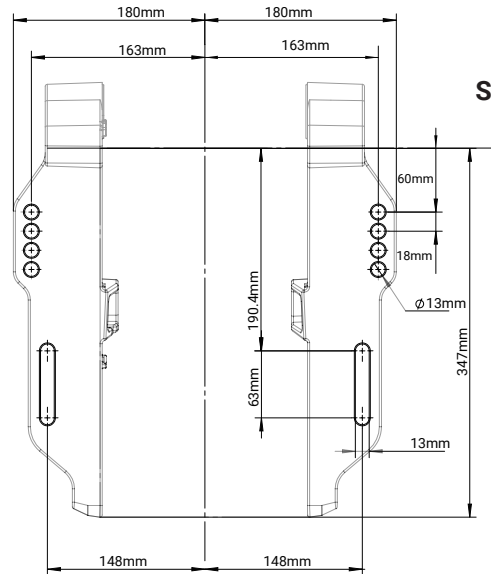

Step 1

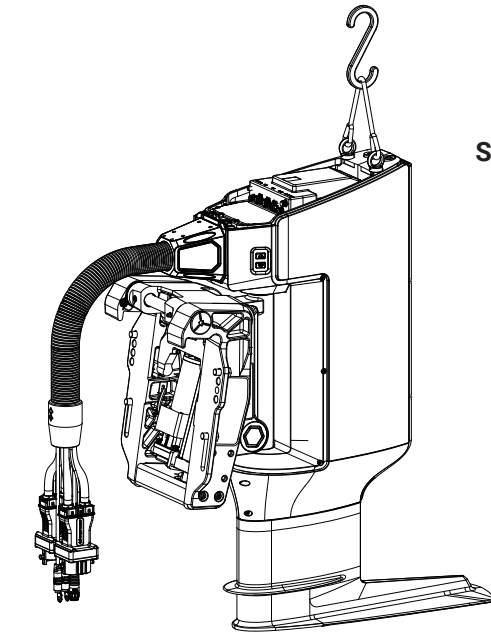

Step 3

**Step 4: Fix the outboard motor**  
Slowly move the outboard to the installation position; Adjust the alignment of the holes, insert the bolts, washers, nuts and double nuts as shown in the picture below, and tighten them securely; Apply the silicone sealant (ThreeBond 1216 or equivalent) to the outboard motor installation holes.  
Standard Torque: 65 N·m( 6.62kgf\*m,47.9lbf\*ft)

**Step 5: Install the top cover**  
Remove the two lifting rings, put the cover back to original position and tighten it with four M5 screws.

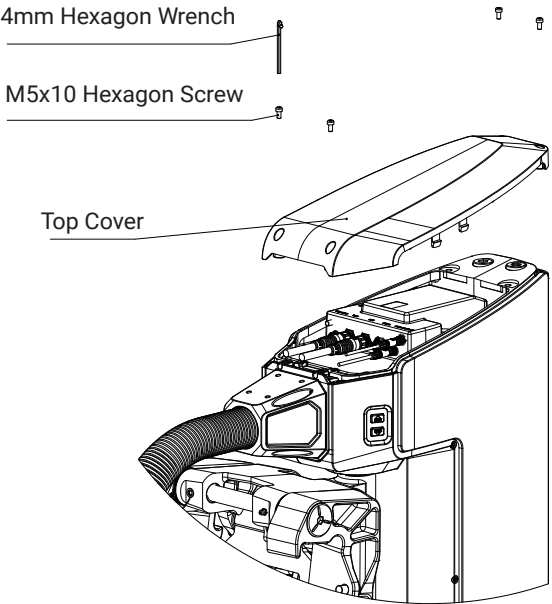

Step 2

Step 4

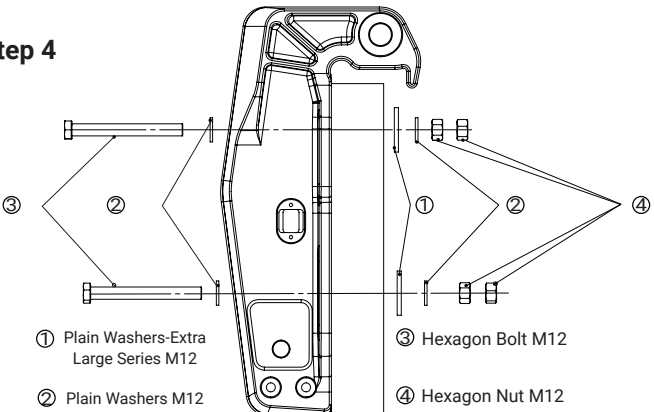

- ① Plain Washers-Extra Large Series M12
- ② Plain Washers M12
- ③ Hexagon Bolt M12
- ④ Hexagon Nut M12

Standard Torque: 65 N·m ( 6.62kgf\*m,47.9lbf\*ft )

296